

THIS DRAWING IS UNPUBLISHED. RELEASED FOR PUBLICATION
 © COPYRIGHT BY TYCO ELECTRONICS CORPORATION. ALL RIGHTS RESERVED.

LOC	DIST	REVISIONS					
G	05	P	LTR	DESCRIPTION	DATE	DWN	APVD
		1		PROPOSED	10JAN08	JR	MS

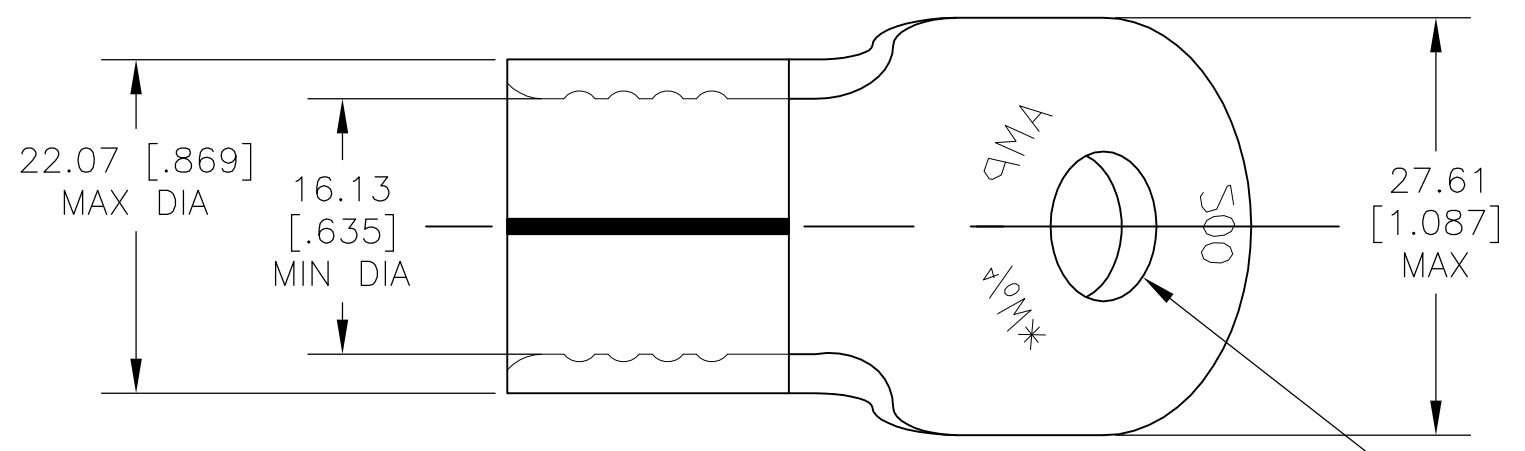

AMP WIRE RANGE	Listed FILE E13288	LR7189 Certified
4/0 AWG SOLID OR STRANDED	N/A	N/A

- ① COPPER PER ASTM B152, ANNEALED
- ② TIN PLATE PER ASTM B-545
- ③ PRELIMINARY - NOT FOR PRODUCTION

9.91±0.13
 [.390±.005] DIA
 FOR 3/8 STUD

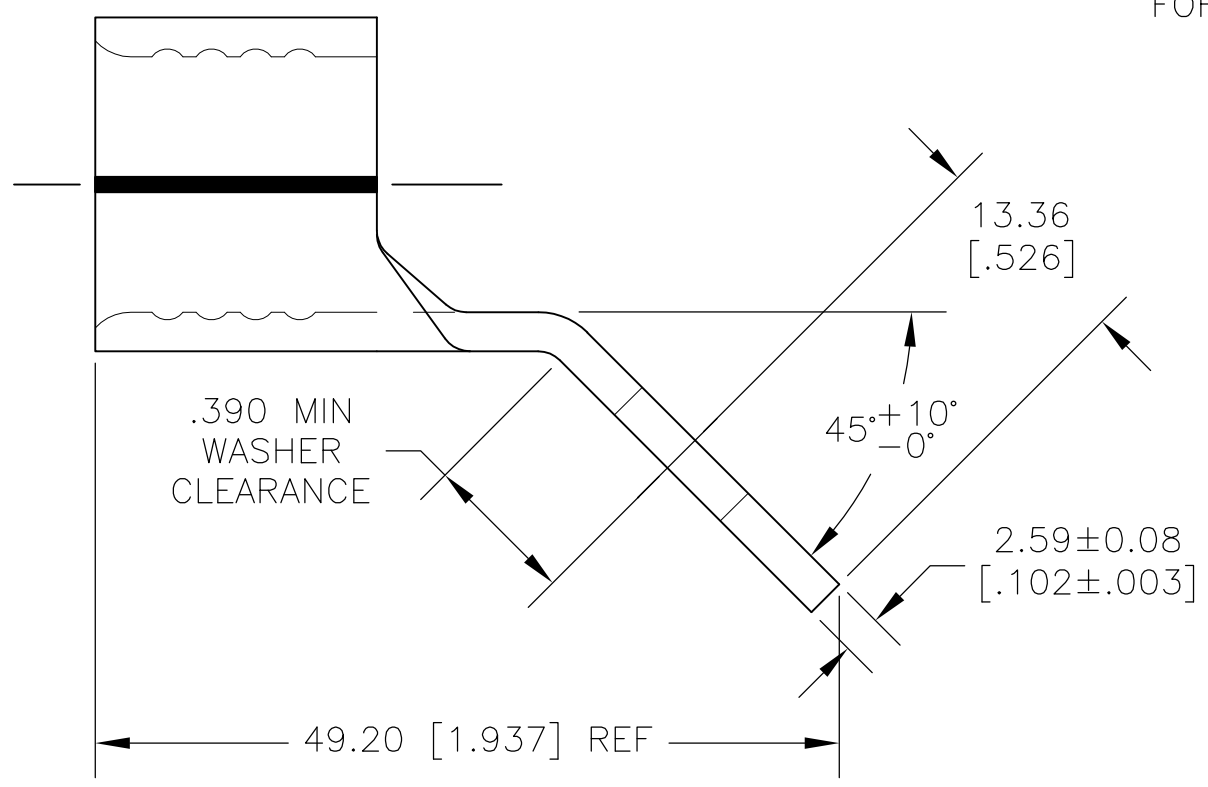

③ 1958185-1
 PART NUMBER

AMP INCORPORATED CUSTOMER SERVICE SYSTEMS	
FOR ADDITIONAL PRODUCT INFORMATION OR COPIES OF DRAWINGS AND TECHNICAL DOCUMENTS	PRODUCT INFORMATION CENTER 1-800-522-6752
FOR APPLICATION TOOLING INFORMATION	TOOLING ASSISTANCE CENTER 1-800-722-1111
FOR ORDER ENTRY	1-800-526-5142

MAX RECOMMENDED OPERATING TEMPERATURE: 170°C MAX
VOLTAGE RATING: N/A
CIRCULAR MIL AREA: 96.3-117.0mm ² [190,000-231,000] SOLID OR STRANDED

THIS DRAWING IS A CONTROLLED DOCUMENT.	
DIMENSIONS: MM[INCHES]	TOLERANCES UNLESS OTHERWISE SPECIFIED:
	0 PLC ± -
	1 PLC ± -
	2 PLC ± 0.20 [.008]
	3 PLC ± -
	4 PLC ± -
	ANGLES ± -
MATERIAL	FINISH
①	②

DWN	JR RUTH	10JAN08
CHK	MIKE SPICER	10JAN08
APVD	MIKE SPICER	10JAN08
PRODUCT SPEC	-	
APPLICATION SPEC	-	
WEIGHT	-	

Tyco Electronics				Tyco Electronics Corporation Harrisburg, PA 17105-3608	
NAME				TERMINAL, RING TONGUE, SOLISTRAND BENT 45	
SIZE	CAGE CODE	DRAWING NO	RESTRICTED TO		
A3	00779	C-1958185	-		
CUSTOMER DRAWING			SCALE	SHEET	REV
			2:1	1 OF 1	1