

NOTES: UNLESS OTHERWISE SPECIFIED.

1. ALL DIMENSIONS ARE IN mm.
TOLERANCES TO BE ± 0.25 mm.
2. PARTS SPECIFIED AS FOLLOWS:

2-1. ENCLOSURE:

- * MATERIAL: GE LEXAN 945,
V-0 RATED FLAMMABILITY.
- * COLOR: GE BLACK (BK1D097).
- * TEXTURE: MT-11020 (MAT).

2-2. AC RECEPTACLE:

- * IEC 320, C6 CERTIFIED, 3 WAY.
- * COLOR: BLACK PER MAKER.

2-3. DC OUTPUT (FERRITE CORE):

- * CONNECTOR: FORK TYPE WITH
LOCK NOTCH.

DIELECTRIC: PANTONE XXX PBT RESIN.

- * CORE: RH 11.5*4.9*25
- * CABLE: UL AWM 1571,
WIRE #20 & SPIRAL #20.
- * JACKET COLOR: BLACK.

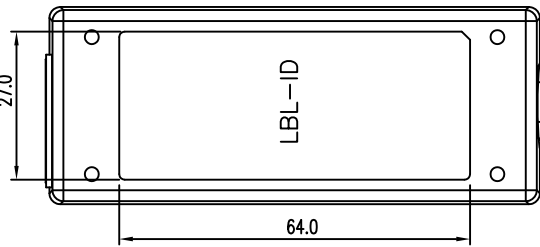
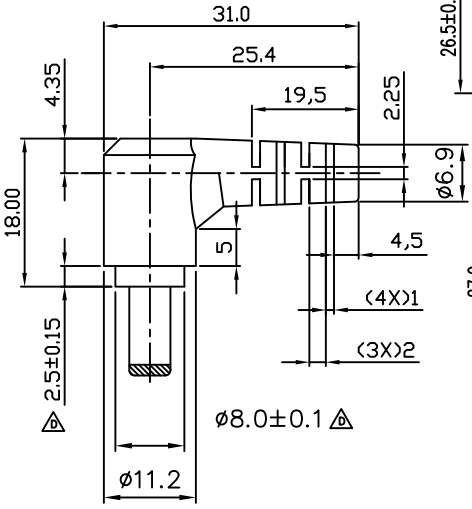
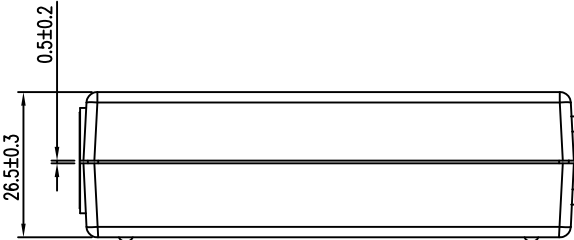
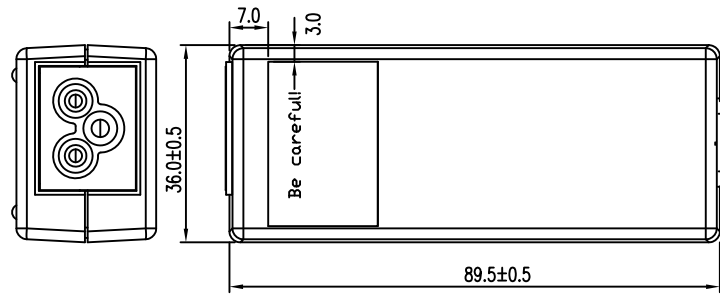
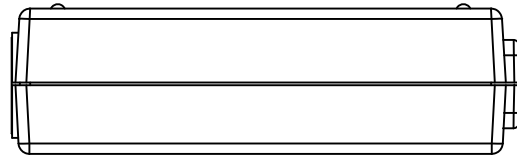

L=1800.0±25.0

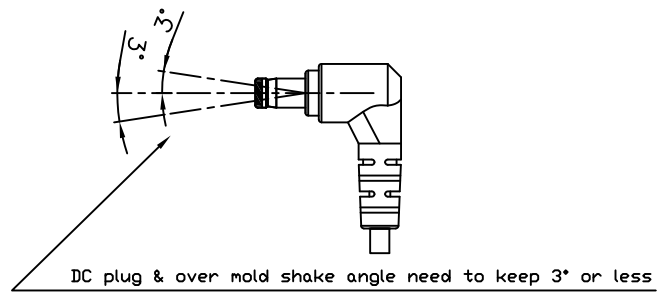
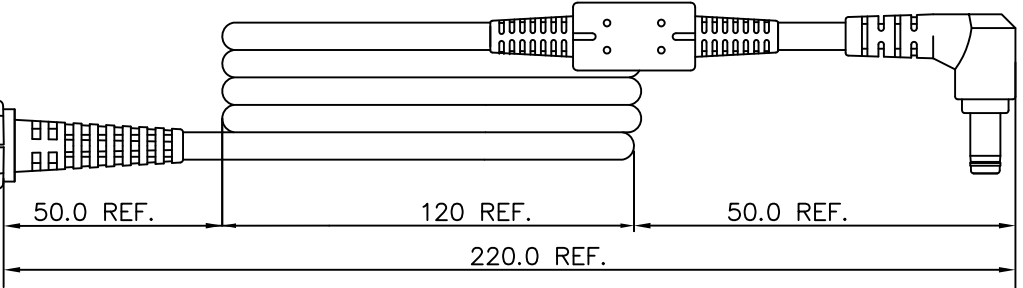
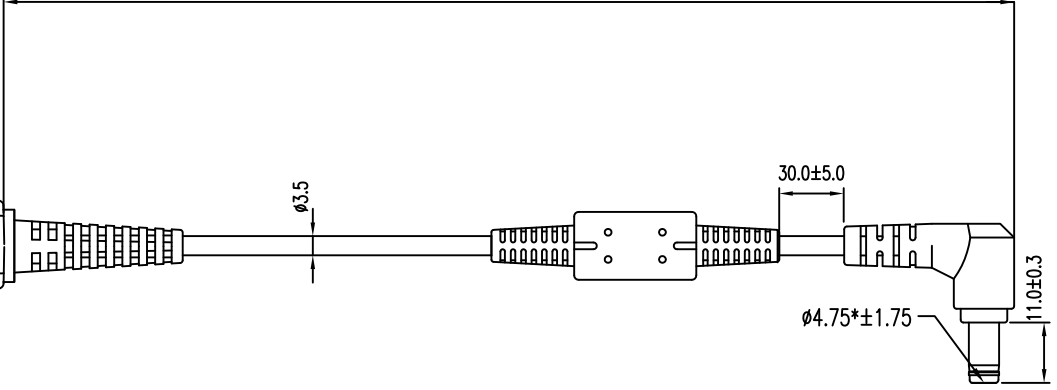

DC plug & over mold shake angle need to keep 3° or less

REVISION	RELEASED	14-AUG-2012	1A-8F	PRINTING DATE	13-AUG-2007	2D FILE	OUTLINE_PA-1300-04CO	DESIGNER	MIKA CHUANG	LITEON	TITLE: OUTLINE DRAW.	PART NO:	
	DESCRIPTION	DATE	ZONE	UNIT: mm	SCALE:	3D FILE		CHECKER		LITE-ON ELECTRONICS, INC.	PROJECT: PA-1300-04CO	DRAWING NO:	D-001387
								APPROVED					REV: A